

## Specs:

Bedrooms:	3
Bathrooms:	2
Square Footage:	2,001 Sq.Ft.
First Level:	1,641 Sq. Ft.
Second Level:	360 Sq. Ft.
Width:	39' - 10"
Depth:	60' - 10"

## Options Shown:

- |   |                 |
|---|-----------------|
| 1 Covered Porch   | 7 Built-ins     |
| 2 Screened in Porch   | 8 Open Rails    |
| 3 Sunroom (Adds 144 Sq.Ft.)   | 9 Chef's Island |
| 4 3'-0" Wider Garage w/ Two Doors                                       | 10 Dormer       |
| 5 Bath-3 (Adds 119 Sq.Ft.)  |                 |
| 6 Bath-3 and Bedroom-4 (Adds 294 Sq.Ft.) Tankless water heater required |                 |

Watercolors, illustrations, and floor plans are for marketing purposes only and are subject to change at builder's discretion. Square footage is outside veneer and should be independently verified. This is not a legal document.

6/7/2023 6:03:12 PM

# FLOOR PLAN: JUDY CLASSIC

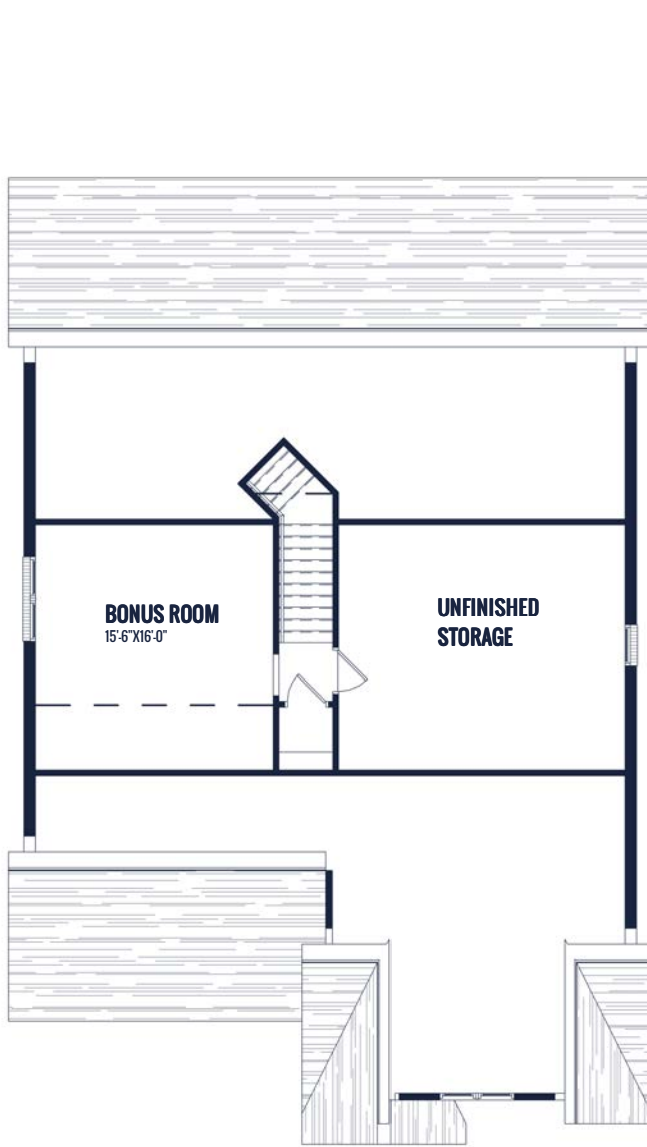
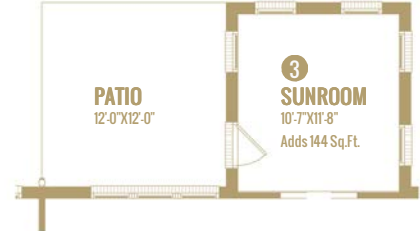
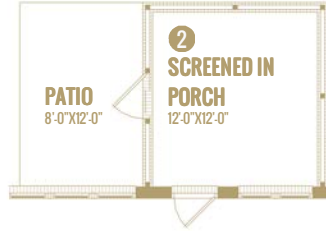
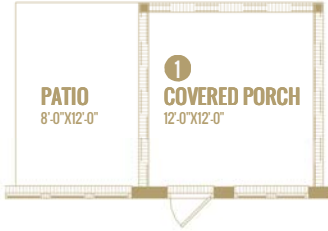

**UPPER LEVEL**



**MAIN LEVEL**

Watercolors, illustrations, and floor plans are for marketing purposes only and are subject to change at builder's discretion. Square footage is outside veneer and should be independently verified. This is not a legal document.

6/7/2023 6:03:14 PM

# FLOOR PLAN: JUDY CLASSIC

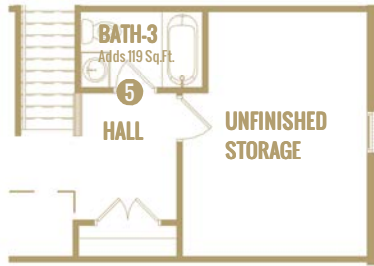

BATH-3

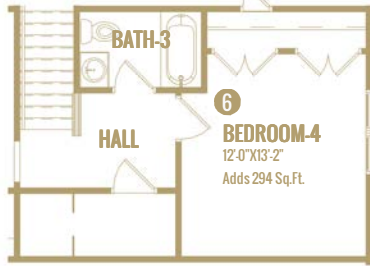

BATH-3 AND BEDROOM-4



OPEN RAILS



BUILT-IN



CHEF'S ISLAND

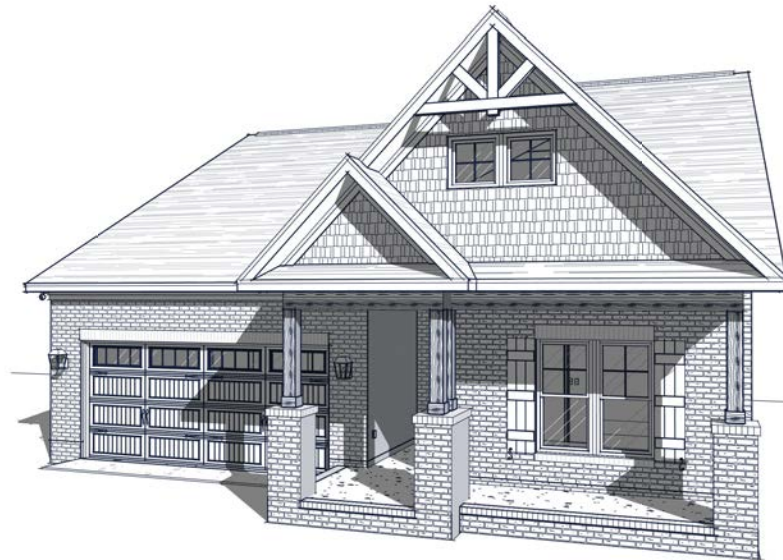

4 3'-0" WIDER GARAGE W/ TWO DOORS

Watercolors, illustrations, and floor plans are for marketing purposes only and are subject to change at builder's discretion. Square footage is outside veneer and should be independently verified. This is not a legal document.

6/7/2023 6:03:18 PM